

PORTHOS POSTERIOR CERVICAL SPINAL FIXATION SYSTEM



**Perfect for
cervical spine
stabilization**

PORTHOS Posterior Cervical Spinal Fixation System HIGHLIGHTS

- ♀ Titanium raw material
- ♀ Provides immobilization and stabilization of spinal segments as an adjunct to fusion
- ♀ Allows for easier screw fixation in difficult anatomy
- ♀ Low profile structure
- ♀ Wide range of implant choices
- ♀ Smart instruments





PORTHOS POSTERIOR CERVICAL SPINAL FIXATION SYSTEM

PURPOSE OF USAGE

The Porthos Posterior Cervical Fixation Systems are performed to treat instabilities which arise from: degenerative disc disease, spondylolisthesis, spinal stenosis, fracture/dislocation, atlantoaxial fractures with instability, occipito-cervical dislocation, revisions of previous cervical spine surgery and tumors and aim to return the segmental movement and load pattern of the spine to normal, and to reduce the load on the disk and posterior elements. They are spinal fixation systems that can be used with hooks, rods and connectors in degenerative spinal diseases and spinal deformities.

INDICATIONS

- ♀ Fractures of laminae, pedicles, facets
- ♀ Articular facet dislocation (unilateral & bilateral)
- ♀ Posterior ligamentous incompetence
- ♀ Spondylosis
- ♀ Articular facet arthropathy
- ♀ Intervertebral disc degeneration
- ♀ Postlaminectomy kyphosis
- ♀ Rheumatoid arthritis
- ♀ Ankylosing spondylitis
- ♀ Osteomyelitis (bacterial, fungal, tuberculous)





PORTHOS POSTERIOR CERVICAL SPINAL FIXATION SYSTEM

PORTHOS POLYAXIAL SCREW

Size	Reference Number
Ø3.5X8	PR358
Ø3.5X10	PR3510
Ø3.5X12	PR3512
Ø3.5X14	PR3514
Ø3.5X16	PR3516
Ø3.5X18	PR3518
Ø3.5X20	PR3520
Ø3.5X22	PR3522
Ø3.5X24	PR3524
Ø3.5X26	PR3526
Ø3.5X28	PR3528



Size	Reference Number
Ø4.0X8	PR408
Ø4.0X10	PR410
Ø4.0X12	PR412
Ø4.0X14	PR414
Ø4.0X16	PR416
Ø4.0X18	PR418
Ø4.0X20	PR420
Ø4.0X22	PR422
Ø4.0X24	PR424
Ø4.0X26	PR426
Ø4.0X28	PR428

PORTHOS POLYAXIAL SHAFT SCREW

Size	Reference Number
Ø3.5X18	PCR3518
Ø3.5X20	PCR3520
Ø3.5X22	PCR3522
Ø3.5X24	PCR3524
Ø3.5X26	PCR3526
Ø3.5X28	PCR3528
Ø3.5X30	PCR3530
Ø3.5X32	PCR3532
Ø3.5X34	PCR3534
Ø3.5X36	PCR3536
Ø3.5X38	PCR3538
Ø3.5X40	PCR3540



Size	Reference Number
Ø4.018	PCR4018
Ø4.0X20	PCR4020
Ø4.0X22	PCR4022
Ø4.0X24	PCR4024
Ø4.0X26	PCR4026
Ø4.0X28	PCR4028
Ø4.0X30	PCR4030
Ø4.0X32	PCR4032
Ø4.0X34	PCR4034
Ø4.0X36	PCR4036
Ø4,0X38	PCR4038
Ø4,0X40	PCR4040

PORTHOS POSTERIOR CERVICAL SPINAL FIXATION SYSTEM



PORTHOS PREBEND ROD



Size	Reference Number
Ø3-Ø4-Ø3X200	PBR200

PORTHOS LAMINAR HOOK



Size	Reference Number
5X5	PLOH

PORTHOS DUAL ROD

Size	Reference Number
Ø3(150mm) Ø5.5(150mm) X400	PORT-CCR3055/400
Ø3(150mm) Ø6.0(150mm) X400	PORT-CCR3060/400



PORTHOS ROD

Size	Reference Number
Ø3.0X50	POR50
Ø3.0X60	POR60
Ø3.0X70	POR70
Ø3.0X80	POR80
Ø3.0X90	POR90
Ø3.0X100	POR100
Ø3.0X110	POR110
Ø3.0X120	POR120
Ø3.0X150	POR150
Ø3.0X180	POR180
Ø3.0X200	POR200
Ø3.0X250	POR250

PORTHOS TRANSVERSE CONNECTOR

Size	Reference Number
50mm-S	PTC-S
60mm-M	PTC-M
70mm-L	PTC-L



PORTHOS POSTERIOR CERVICAL SPINAL FIXATION SYSTEM



PORTHOS NUT TORX



Size	Reference Number
T25	OLN01

PORTHOS DOMINO CONNECTOR

Size	Reference Number
2HOLE - Ø3.0XØ5.5	PORDC-MDLS
2 HOLE - Ø3.0XØ6.0	PORDC-MDLS
2 HOLE - Ø3.0XØ6.0	PORDC-SCS
2 HOLE - Ø3.0XØ3.0	PORMLC-2H
4 HOLE - Ø3.0XØ3.0	PORMLC-4H

PORTHOS OCCIPITAL PLATE SCREW



Size	Reference Number
Ø4.0X4	CS404
Ø4.0X6	CS406
Ø4.0X8	CS408
Ø4.0X10	CS410
Ø4.0X12	CS412
Ø4.0X14	CS414
Ø4.5X4	CS454
Ø4.5X6	CS456
Ø4.5X8	CS458
Ø4.5X10	CS4510
Ø4.5X12	CS4512
Ø4.5X14	CS4514



PORTHOS OCCIPITAL PLATE

Size	Reference Number
S	POP-S
M	POP-M
L	POP-L



PORTHOS CLOSED LATERAL CONNECTOR

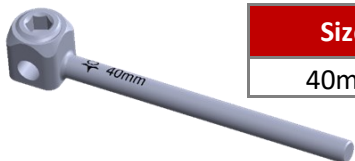

Size	Reference Number
40mm	PORCLC40

PORTHOS OPENED LATERAL CONNECTOR



Size	Reference Number
40mm	POROLC40