

evo

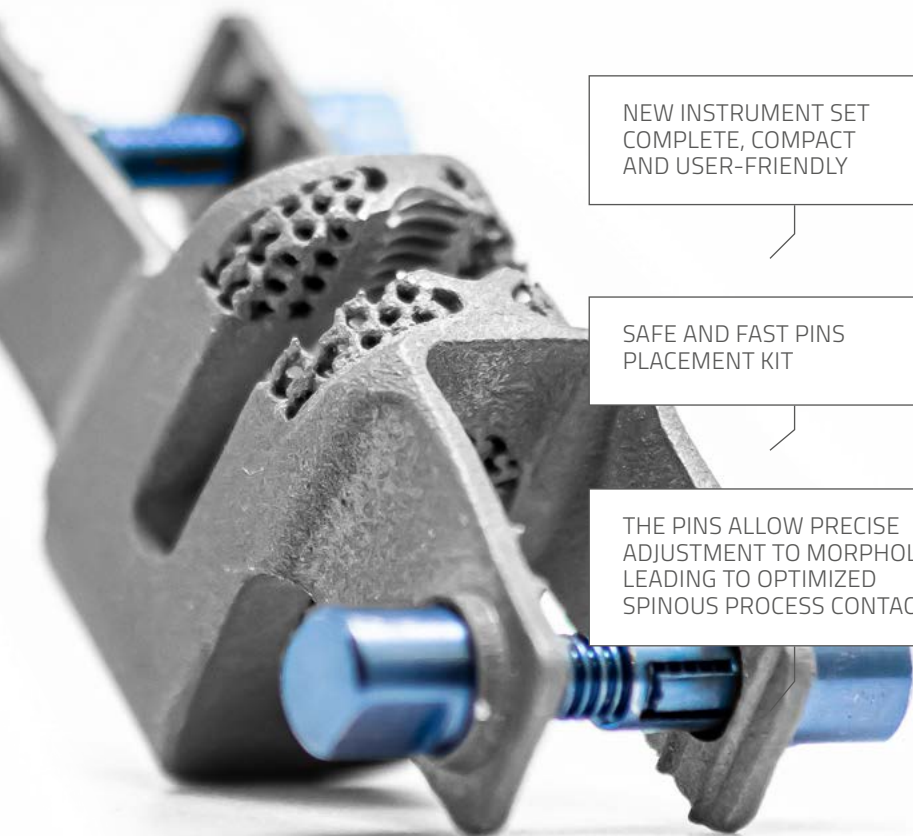

NEW INSTRUMENT SET COMPLETE, COMPACT AND USER-FRIENDLY

SAFE AND FAST PINS PLACEMENT KIT

THE PINS ALLOW PRECISE ADJUSTMENT TO MORPHOLOGY LEADING TO OPTIMIZED SPINOUS PROCESS CONTACT.

TRABECULAR TITANIUM CORE GUARANTEES FAST BONE INTEGRATION AND GREAT ARTHRODESIS ACHIEVEMENT

PREBEND WINGS ALLOW EASIER NON TRAUMATIC INSERTION INTO THE INTERSPINOUS SPACE

NEW DESIGN FOR AN EFFECTIVE INTERLAMINAR FUSION

Interlaminar fusion system

Evo is an innovative interlaminar fusion device totally made with 3D printing technology, composed of a macrostructure in trabecular titanium that promotes rapid bone growth.

Its central body in trabecular titanium - perforated both in the craniocaudal and lateral direction - allows the surgeon to insert a greater quantity of bone graft which increases the reachable area of arthrodesis.

The implant positioning system is intuitive and immediate, as is the new tool to tighten the pins on the prickles. This allows Evo to reduce the range of movements, bringing it closer to that obtained with the screw and rod system.





Main features



TRABECULAR TITANIUM



3D PRINTING TECH



ETO STERILIZED

Instrument design

Clover has invested heavily in the design and care of the instruments with the aim of creating ergonomic, functional and compact instrumentation. Designed for the surgeon and the operating equip.

#LESSISMORE



SPACERS	H8 H10 H12 H14 H16
LOCKING PIN	SHORT LONG

misano 

monza 

evo 

DIKI 

SPIT FIX 

rally 

pick-up 



Clover Orthopedics s.r.l.
Via Gadames n. 57/7, c.a.p. 20151 Milano

M. info@cloverorthopedics.com
W. cloverorthopedics.com

T. +39 02 457 902 31
F. +39 02 457 902 66

