

IN:C2™

Now Open for Fusion

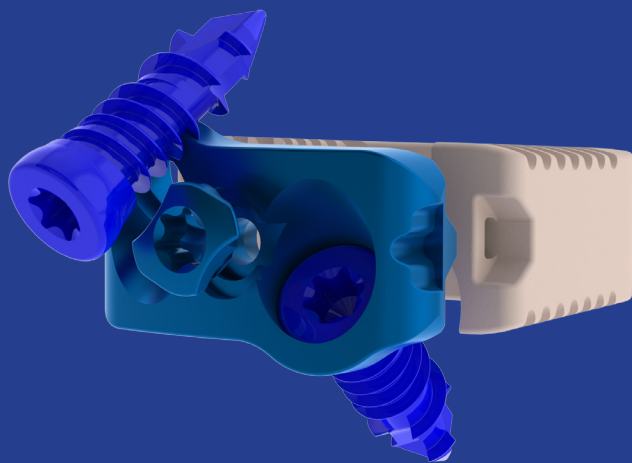

Product Range & Sizing

Footprints (Width X Length)	Small: 11.5 mm (L) x 14 mm (W) Medium: 13 mm (L) x 16 mm (W) Large: 15 mm (L) x 18 mm (W)
Lordosis	6°
Height	5, 6, 7, 8, 9, 10 or 11 mm
Plating Options	Zero Profile or Anterior Fixation
Screws	CorticoCancellous, Dual Lead or Resuce
Fixation Style	Constrained

Locking Mechanism Provides
Visual and Tactile Assurance



Zero Profile
Plate

Posterior Threaded
Marker

Open Anteriorly for
Autograft Placement

PEEK

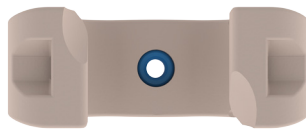

Anterior Fixation
Plate

Open Anteriorly for
Modular Plating Options



IN:C2™- Features & Benefits

- Modular plating options with multiple screw placement and trajectories
- **Radiolucent** and biocompatible
- Locking **snap-on** face plate
- **CorticoCancellous** screw option
- Open window **maximizes graft placement**